



Billet Performance Products

Ph: +61 7 5670 8882 Web: www.billet.net.au Email: enquiries@billet.net.au
ABN: 88 116 168 346

INSTALLATION MANUAL

Billet Performance Products RB26 14mm Fuel Rail Kit

ITEMS INCLUDED IN FUEL RAIL KIT

- (1) FUEL RAIL
- (2) FUEL RAIL BRACKET
- (2) FUEL RAIL POST
- (2) -6 TO -8 FUEL RAIL FITTING
- (1) AN -6 O-RING ADAPTOR PLUG SEAL
- (2) M8 x 40MM BOLT
- (2) M8 FLAT WASHER
- (2) M8 SPRING WASHER
- (4) M6 x 12MM BOLT
- (4) M6 SPRING WASHER
- (1) -6 90DEG O-RING PORT ADAPTOR
- (6) ID INJECTOR SEAL
- (1) SILICONE GREASE

ITEMS REQUIRED WHEN REPLACING THE FACTORY FUEL RAIL KIT

- -6 OR -8 AN HOSE FITTINGS
- FUEL HOSE FOR FUEL FEED & RETURN LINE
- AFTERMARKET FUEL REGULATOR
- AFTERMARKET 14MM O-RING FUEL INJECTORS

PLEASE READ CAREFULLY BEFORE PROCEEDING WITH INSTALLATION

PRODUCT DISCLAIMER

- There is no warranty stated or implied due to the unusual stresses placed on competition products and/or the inability to monitor the modification, installation and use. The entire risk of quality, performance and defect is with the purchaser and not the manufacturer, distributor or retailer. Should any product(s) prove to be defective for any reason under any circumstance, the purchaser and not the manufacturer, distributor or retailer will assume financial responsibility for any consequential damages, repairs/service and any other liability.
- A Vehicle modified by the use of competition product(s) for use on public roadways may not meet local state or federal regulations. Installation and use of this competition product(s) may also affect vehicle insurance coverage. It is the purchaser's responsibility to meet and comply with regulations and policies before operating the vehicle on public roadways.
- Return of product(s) will **ONLY** be accepted if product(s) is in resalable condition. All accepted returns will be subject to a 20% restocking fee. **ABSOLUTELY NO RETURNS ON USED PRODUCTS.**
- **For technical support, please contact us via email enquiries@billet.net.au or call +61 7 5670 8882**

WARRANT POLICY

Billet Performance Products warrants all products to be free of defects in materials and workmanship for normal use and service for a period of 90 days from the date of retail purchase. Products returned must be inspected and determined to be defective by Billet Performance Products before any warranty credit and/or replacement is issued. Billet Performance Products' obligation under warranty shall be limited to repairing or replacing, at its discretion, any product found to be defective. The consumer will be responsible for transportation charges. Final determination of the suitability of the product(s) for the intended use is the sole responsibility of the consumer. Billet Performance Products shall not be liable for any special, direct, indirect, incidental or consequential damages that may be claimed as a result of the failure of any product, including claims of delay, loss of profits or labor. Billet Performance Products shall not be liable for any damage and/or injury to person(s) and/or property resulting from improper installation and/or misuse of any product subject to this warranty. There is no other warranties expressed and/or implied extending beyond those set forth above.

Note: This fuel rail kit requires the removal and reinstallation of fuel system related components. If you are not familiar with the installation and/or the operation of these components then please refer this installation to a qualified professional.

WARNING!

- Keep open flames and/or spark away from vehicle at all times when removing and refitting fuel rail.
- Thoroughly clean your new Billet Performance Products fuel rail before installation.
- Be sure engine is off before you relieve the fuel pressure from vehicle.

INSTALLATION INSTRUCTIONS

Step 1: Removal

1. Please refer to a factory service manual for the removal of the factory fuel rail.
2. Disconnect negative battery terminal before proceeding.
3. Clean the area around the fuel rail so that dirt cannot get into the engine.
4. Remove the fuel filter cap and undo banjo bolt on filter slightly to relieve all pressure.
5. Carefully disassemble the factory fuel rail.
 - a. Ensure the vehicle is parked on a level surface.

Step 2: Assembling the Billet Performance Products Fuel Rail

1. Install the -6 to -8 Fuel rail fitting supplied using a small amount of silicone grease to either end of the fuel rail (Fig 1 and 2).
2. Install either the -6 o-ring plug or -6 AN fitting using a small amount of silicone grease supplied to center of rail depending on whether a dual or single feed is intended for the application.
3. Install left & right fuel rail bracket to fuel rail.
4. Install the aftermarket fuel injectors to fuel rail using a small amount of silicone grease supplied on injector O-rings.
 - a. Aftermarket fuel injectors must be used. The Billet Performance Products fuel rail is designed for 60mm O-ring to O-ring injectors measured from inside to inside of O-ring.
 - b. Make sure the fuel injectors are properly seated in the Billet Performance Products fuel rail.

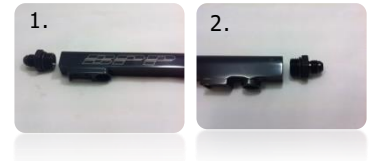

Step 3: Installation

1. Install the Billet Performance Products fuel rail using the provided spacers and bolts.
 - a. Do not fully tighten the fuel rail until the fuel injectors are correctly seated into the intake manifold.
 - b. Be careful not to damage the seals in the intake manifold.
2. Tighten the mounting bolts.
 - a. Do not over tighten the bolts; doing so may cause damage to the fuel rail.
3. Make up appropriate hoses and install the fuel pressure regulator
 - a. An aftermarket fuel pressure regulator must be installed please consult a professional for options on aftermarket fuel pressure regulators.
4. Install the fuel feed and return line. **Make sure that there is enough slack on the hoses to not place pressure on the fuel rail with engine movement.**
5. Reconnect wiring harness and all connectors. Factory Connectors may need to be changed to suit injectors.
6. Connect the negative battery terminal.
7. Turn the ignition switch to the on position for approximately two seconds and turn the ignition switch to the off position. **DO NOT ATTEMPT TO START ENGINE.**
 - a. Repeat this procedure three times, and then check all components that were removed during installation for any signs of fuel leakage.
 - b. **Check all fittings for leaks**
 - c. If there are signs of leakage, you **MUST** correct the leak before proceeding.

- d. **If larger and/or aftermarket injectors are being fitted ensure vehicle ECU has been adjusted to suit before attempting to start vehicle.**
8. If there are no signs of leakage, then start engine and again check for leaks.
9. If there is no sign of leakage on final inspection, then the installation is complete.

*For more information or Technical Enquiries
Contact Billet Performance Products on
+61 7 5670 8882 or enquiries@billet.net.au*